

公司简介 About us

常州市北方合金工具有限公司是从事硬质合金刀具生产、设计、销售的专业化企业。公司先后引进德国Michael Deckel澳大利亚ANCA, 瑞士TTB公司的数控刀具磨床以及德国EQUER公司的刀具检测仪。主要生产硬质合金铣削刀具、孔加工工具, PCD行业专用刀具并可为客户设计各种非标刀具。产品广泛应用于机械加工, 汽车, 模具, 塑胶等各类机械加工领域。

公司以“靠质量求生存, 凭信誉谋发展”为宗旨, 带着最优的品质, 最具竞争力的价格和良好的服务态度, 北方将以完全的自信来满足您的需求。

Changzhou North Carbide Tool CO., Ltd is a professional integrated enterprise not only specialized in Research and Develop, but also good at manufacturing solid carbide cutting tools and pushing them to market. In recent years, North Carbide Tool has introduced advanced CNC grinding machines from German Michael Deckel, Australia ANCA and Switzerland TTB. What's more, advanced tool test instrument from German EQUER has been introduced.

North Carbide Tool mainly manufactures solid carbide milling and turning tools, drilling tools, special tools for PCD area, meanwhile, varieties of non-standard cutting tools can be designed for clients. All the products are widely applied in the area of machinery processing, like automobile, Die, plastic and so on.

North Carbide Tool is always in the aim of "Survive from Quality, develop from prestige". With the best quality, the competitive price and the best attitude of service, we are confident to meet your needs.



Contents Index 目录索引

常州市北方合金工具有限公司



ChangZhou North Carbide Tool Co., Ltd.

05 450二刃、四刃平底刀 450 2/4 Flutes Flat End Mill	23 深沟刀 Long Neck Flute End Mill	
06 450二刃、四刃球刀 450 2/4 Flutes Ball Nose End Mill	24 螺旋丝锥 Spiral Flute Tap	
07 550二刃、四刃平底刀 550 2/4 Flutes Flat End Mill	24 直槽丝锥 Straight Flute Tap	
08 550二刃、四刃球刀 550 2/4 Flutes Ball Nose End Mill	24 螺纹铣刀 Thread Mills	
09 600二刃、四刃平底刀 600 2/4 Flutes Flat End Mill	25 内冷钻 3xD Cold Drill 3xD	
10 600二刃、四刃球刀 600 2/4 Flutes Ball Nose End Mill	26 内冷钻 5xD Cold Drill 5xD	
11 650二刃、四刃平底刀 650 2/4 Flutes Flat End Mill	27 中心钻 Center Drill	
12 650二刃、四刃球刀 650 2/4 Flutes Ball Nose End Mill	27 麻花钻 Twist Drill	
13 450二刃、四刃圆鼻刀 450 2/4 Flutes Corner Radius End Mill	28 铰刀 Reamer	
14 550二刃、四刃圆鼻刀 550 2/4 Flutes Corner Radius End Mill	28 定点钻 Fixed-point drill	
15 600二刃、四刃圆鼻刀 600 2/4 Flutes Corner Radius End Mill	29 整体硬质合金锯片铣刀 Solid carbide saw blade cutter	
16 500/600超角刀二刃、三刃45° 55° 500/600 Ultra Angle Processing End Mill 45° 55°	30 焊接铰刀 Welding Reamer	
17 单刃螺旋铣刀 One Spiral Flute Bits	30 焊接铰刀 Welding cutter	
17 单刃锥度雕刻刀 Flat Bottom Engraving Bits	31 T型刀 T-slot milling cutter	
18 六刃精铣刀 6 Flutes Finishing End Mill	32 刀柄系列 Handle series	
19 三刃、四刃粗皮刀 3/4 Flutes Roughing End Mill	33 PCD系列 PCD series	
20 二刃、四刃斜度刀 2/4 Flutes Taper End Mill	33 非标系列 Non-standard series	
21 二刃斜度圆球刀 2 Flutes Taper Ball Nose End Mill	34-35 技术资料 端铣加工中问题及对策	
22 微小径平刀、球刀 Micro-diameter Flat End Mill And Ball Nose End Mill	36-39 切削数据表 Cutting Data Parameters	

细微粒碳化钨 Micro Grain Carbide



450二刃、四刃平底刀
450 2/4 Flutes Flat End Mill

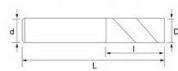

● 适合加工: 铜、铸钢、硬钢、模具钢。
● 主要特性: 细颗粒碳化钨晶粒结构, 硬度高, ALTN氮化钛涂层, 耐磨, 第一道的涂层, 专用于CNC高速切削, 能降低切削力, 降低切削温度, 减少粉尘, 提高机床效率, 节省工件制作时间。
● Suitable for copper, Cast iron, Carbon steel, and Mould steel processing.
● Main Features: Grain size carbon tungsten, high toughness, ALTN coating, high wear-resistance, special use for high speed cutting of CNC milling machine. Also can increase the smoothness, reduce the rubbing coefficient, and improve the lathe efficiency, save more production time.

产品编号 Item Code	刃径(D) Outside Diameter	柄径(d) Shank Diameter	刃长(l) Flute Length	全长(L) Overall Length
BFL-ED-010	1.0	4	3	50
BFL-ED-015	1.5	4	4	50
BFL-ED-020	2.0	4	6	50
BFL-ED-025	2.5	4	8	50
BFL-ED-030	3.0	3	8	50
BFL-ED-031	3.0	4	8	50
BFL-ED-035	3.5	4	11	50
BFL-ED-040	4.0	4	11	50
BFL-ED-010	1.0	6	3	50
BFL-ED-015	1.5	6	4	50
BFL-ED-020	2.0	6	6	50
BFL-ED-030	3.0	6	8	50
BFL-ED-040	4.0	6	11	50
BFL-ED-045	4.5	6	13	50
BFL-ED-050	5.0	5	13	50
BFL-ED-051	5.0	6	13	50
BFL-ED-060	6.0	6	15	50
BFL-ED-070	7.0	8	20	60
BFL-ED-080	8.0	8	20	60
BFL-ED-090	9.0	10	25	75
BFL-ED-100	10.0	10	25	75
BFL-ED-120	12.0	12	30	75
BFL-ED-140	14.0	14	45	100
BFL-ED-160	16.0	16	45	100
BFL-ED-180	18.0	18	45	100
BFL-ED-200	20.0	20	45	100

加长型 Extra Length Type

产品编号 Item Code	刃径(D) Outside Diameter	柄径(d) Shank Diameter	刃长(l) Flute Length	全长(L) Overall Length
BFL-LED-040	4.0	4	11	75
BFL-LED-041	4.0	4	11	100
BFL-LED-050	5.0	6	13	75
BFL-LED-060	6.0	6	15	75
BFL-LED-081	6.0	6	15	100
BFL-LED-062	6.0	6	40	150
BFL-LED-080	8.0	8	20	75
BFL-LED-081	8.0	8	20	100
BFL-LED-082	8.0	8	40	150
BFL-LED-100	10.0	10	25	100
BFL-LED-101	10.0	10	50	150
BFL-LED-120	12.0	12	30	100
BFL-LED-121	12.0	12	50	150
BFL-LED-140	14.0	14	50	150
BFL-LED-160	16.0	16	50	150
BFL-LED-180	18.0	18	50	150
BFL-LED-200	20.0	20	50	150

细微粒碳化钨

Micro Grain Carbide



450二刃、四刃球刀
450 2/4 Flutes Ball Nose End Mill



● 适合加工：铜、铝、镁、钛、镍、不锈钢、模具钢、钛合金、工具钢、热作模具钢。
● 主要特性：超微粒碳化钨涂层材料，超厚ALTiN涂层，耐磨，非一般涂层，专用于CNC机床高速切削，能增加寿命，提高生产率，减少换刀次数，提高机床效率，节省工件制作时间。

● Suitable for copper, Cast iron, Carbon steel, and Cold steel processing.
● Main features: Grain size carbon tungsten, high toughness, ALTiN coating, high wear-resistance, special use for high speed cutting of CNC milling machine. Also can increase the smoothness, reduce the rubbing coefficient, and improve the lathe efficiency, save more production time.

极细微粒碳化钨

Micro Grain Carbide



550二刃、四刃平底刀
550 2/4 Flutes Flat End Mill

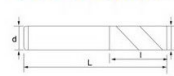

● 适合加工：铜、铝、镁、钛、镍、不锈钢、模具钢、钛合金、工具钢、热作模具钢。
● 主要特性：超微粒碳化钨涂层材料，超厚ALTiN涂层，耐磨，非一般涂层，专用于CNC机床高速切削，能增加寿命，提高生产率，减少换刀次数，提高机床效率，节省工件制作时间。

● Suitable for copper, Cast iron, Carbon steel, Mould steel, Stainless steel, Titanium Alloy, Tool steel, and Heat-treated steel processing.
● Main features: Grain size carbon tungsten, high toughness, ALTiN coating, high wear-resistance, special use for high speed cutting of CNC milling machine. Also can increase the smoothness, reduce the rubbing coefficient, and improve the lathe efficiency, save more production time.

产品编号 Item Code	刃径(D) Outside Diameter	柄径(d) Shank Diameter	刃长(l) Flute Length	全长(L) Overall Length
BFL-AD-010	1.0	4	3	50
BFL-AD-015	1.5	4	4	50
BFL-AD-020	2.0	4	6	50
BFL-AD-025	2.5	4	8	50
BFL-AD-030	3.0	3	8	50
BFL-AD-031	3.0	4	8	50
BFL-AD-035	3.5	4	11	50
BFL-AD-040	4.0	4	11	50
BFL-AD-041	4.0	6	3	50
BFL-AD-042	4.0	6	4	50
BFL-AD-043	4.0	6	5	50
BFL-AD-044	4.0	6	6	50
BFL-AD-045	4.0	6	7	50
BFL-AD-046	4.0	6	8	50
BFL-AD-047	4.0	6	9	50
BFL-AD-048	4.0	6	10	50
BFL-AD-049	4.0	6	11	50
BFL-AD-050	4.0	6	12	50
BFL-AD-051	5.0	6	13	50
BFL-AD-052	5.0	6	14	50
BFL-AD-053	5.0	6	15	50
BFL-AD-054	5.0	6	16	50
BFL-AD-055	5.0	6	17	50
BFL-AD-056	5.0	6	18	50
BFL-AD-057	5.0	6	19	50
BFL-AD-058	5.0	6	20	50
BFL-AD-059	6.0	6	21	50
BFL-AD-060	6.0	6	22	50
BFL-AD-061	6.0	6	23	50
BFL-AD-062	6.0	6	24	50
BFL-AD-063	6.0	6	25	50
BFL-AD-064	6.0	6	26	50
BFL-AD-065	6.0	6	27	50
BFL-AD-066	6.0	6	28	50
BFL-AD-067	6.0	6	29	50
BFL-AD-068	6.0	6	30	50
BFL-AD-069	7.0	8	20	60
BFL-AD-070	7.0	8	21	60
BFL-AD-071	7.0	8	22	60
BFL-AD-072	7.0	8	23	60
BFL-AD-073	7.0	8	24	60
BFL-AD-074	7.0	8	25	60
BFL-AD-075	7.0	8	26	60
BFL-AD-076	7.0	8	27	60
BFL-AD-077	7.0	8	28	60
BFL-AD-078	7.0	8	29	60
BFL-AD-079	7.0	8	30	60
BFL-AD-080	8.0	8	20	60
BFL-AD-081	8.0	8	21	60
BFL-AD-082	8.0	8	22	60
BFL-AD-083	8.0	8	23	60
BFL-AD-084	8.0	8	24	60
BFL-AD-085	8.0	8	25	60
BFL-AD-086	8.0	8	26	60
BFL-AD-087	8.0	8	27	60
BFL-AD-088	8.0	8	28	60
BFL-AD-089	8.0	8	29	60
BFL-AD-090	8.0	8	30	60
BFL-AD-091	9.0	10	25	75
BFL-AD-092	9.0	10	26	75
BFL-AD-093	9.0	10	27	75
BFL-AD-094	9.0	10	28	75
BFL-AD-095	9.0	10	29	75
BFL-AD-096	9.0	10	30	75
BFL-AD-097	10.0	10	25	75
BFL-AD-098	10.0	10	26	75
BFL-AD-099	10.0	10	27	75
BFL-AD-100	10.0	10	28	75
BFL-AD-101	10.0	10	29	75
BFL-AD-102	10.0	10	30	75
BFL-AD-103	11.0	12	30	75
BFL-AD-104	11.0	12	31	75
BFL-AD-105	11.0	12	32	75
BFL-AD-106	11.0	12	33	75
BFL-AD-107	11.0	12	34	75
BFL-AD-108	11.0	12	35	75
BFL-AD-109	11.0	12	36	75
BFL-AD-110	11.0	12	37	75
BFL-AD-111	11.0	12	38	75
BFL-AD-112	11.0	12	39	75
BFL-AD-113	11.0	12	40	75
BFL-AD-114	11.0	12	41	75
BFL-AD-115	11.0	12	42	75
BFL-AD-116	11.0	12	43	75
BFL-AD-117	11.0	12	44	75
BFL-AD-118	11.0	12	45	75
BFL-AD-119	11.0	12	46	75
BFL-AD-120	11.0	12	47	75
BFL-AD-121	11.0	12	48	75
BFL-AD-122	11.0	12	49	75
BFL-AD-123	11.0	12	50	75
BFL-AD-124	11.0	12	51	75
BFL-AD-125	11.0	12	52	75
BFL-AD-126	11.0	12	53	75
BFL-AD-127	11.0	12	54	75
BFL-AD-128	11.0	12	55	75
BFL-AD-129	11.0	12	56	75
BFL-AD-130	11.0	12	57	75
BFL-AD-131	11.0	12	58	75
BFL-AD-132	11.0	12	59	75
BFL-AD-133	11.0	12	60	75
BFL-AD-134	11.0	12	61	75
BFL-AD-135	11.0	12	62	75
BFL-AD-136	11.0	12	63	75
BFL-AD-137	11.0	12	64	75
BFL-AD-138	11.0	12	65	75
BFL-AD-139	11.0	12	66	75
BFL-AD-140	11.0	12	67	75
BFL-AD-141	11.0	12	68	75
BFL-AD-142	11.0	12	69	75
BFL-AD-143	11.0	12	70	75
BFL-AD-144	11.0	12	71	75
BFL-AD-145	11.0	12	72	75
BFL-AD-146	11.0	12	73	75
BFL-AD-147	11.0	12	74	75
BFL-AD-148	11.0	12	75	75
BFL-AD-149	11.0	12	76	75
BFL-AD-150	11.0	12	77	75
BFL-AD-151	11.0	12	78	75
BFL-AD-152	11.0	12	79	75
BFL-AD-153	11.0	12	80	75
BFL-AD-154	11.0	12	81	75
BFL-AD-155	11.0	12	82	75
BFL-AD-156	11.0	12	83	75
BFL-AD-157	11.0	12	84	75
BFL-AD-158	11.0	12	85	75
BFL-AD-159	11.0	12	86	75
BFL-AD-160	11.0	12	87	75
BFL-AD-161	11.0	12	88	75
BFL-AD-162	11.0	12	89	75
BFL-AD-163	11.0	12	90	75
BFL-AD-164	11.0	12	91	75
BFL-AD-165	11.0	12	92	75
BFL-AD-166	11.0	12	93	75
BFL-AD-167	11.0	12	94	75
BFL-AD-168	11.0	12	95	75
BFL-AD-169	11.0	12	96	75
BFL-AD-170	11.0	12	97	75
BFL-AD-171	11.0	12	98	75
BFL-AD-172	11.0	12	99	75
BFL-AD-173	11.0	12	100	75
BFL-AD-174	11.0	12	101	75
BFL-AD-175	11.0	12	102	75
BFL-AD-176	11.0	12	103	75
BFL-AD-177	11.0	12	104	75
BFL-AD-178	11.0	12	105	75
BFL-AD-179	11.0	12	106	75
BFL-AD-180	11.0	12	107	75
BFL-AD-181	11.0	12	108	75
BFL-AD-182	11.0	12	109	75
BFL-AD-183	11.0	12	110	75
BFL-AD-184	11.0	12	111	75
BFL-AD-185	11.0	12	112	75
BFL-AD-186	11.0	12	113	75
BFL-AD-187	11.0	12	114	75
BFL-AD-188	11.0	12	115	75
BFL-AD-189	11.0	12	116	75
BFL-AD-190	11.0	12	117	75
BFL-AD-191	11.0	12	118	75
BFL-AD-192	11.0	12	119	75
BFL-AD-193	11.0	12	120	75
BFL-AD-194	11.0	12	121	75
BFL-AD-195	11.0	12	122	75
BFL-AD-196	11.0	12	123	75
BFL-AD-197	11.0	12	124	75
BFL-AD-198	11.0	12	125	75
BFL-AD-199	11.0	12	126	75
BFL-AD-200	11.0	12	127	75

产品编号 Item Code	刃径(D) Outside Diameter	柄径(d) Shank Diameter	刃长(l) Flute Length	全长(L) Overall Length
BFL-LER-040	R2	4	8	75
BFL-LER-041	R2	4	8	100
BFL-LER-050	R2.5	6	10	75
BFL-LER-060	R3	6	12	75
BFL-LER-061	R3	6	12	100
BFL-LER-062	R3	6	30	150
BFL-LER-080	R4	8	16	75
BFL-LER-081	R4	8	16	100
BFL-LER-082	R4	8	30	150
BFL-LER-100	R5	10	20	100
BFL-LER-101	R5	10	40	150
BFL-LER-120	R6	12	25	100
BFL-LER-121	R6	12	40	150
BFL-LER-140	R7	14	40	150
BFL-LER-160	R8	16	40	150
BFL-LER-180	R9	18	40	150
BFL-LER-200	R10	20	40	150

极细微粒碳化钨

Micro Grain Carbide



550二刃、四刃球刀
550 2/4 Flutes Ball Nose End Mill

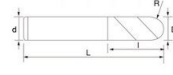

● 适合加工：铜、铝、镁、钛、镍、不锈钢、模具钢、钛合金、工具钢、热作模具钢。
● 主要特性：超微粒碳化钨涂层材料，超厚ALTiN涂层，耐磨，非一般涂层，专用于CNC机床高速切削，能增加寿命，提高生产率，减少换刀次数，提高机床效率，节省工件制作时间。

● Suitable for copper, Cast iron, Carbon steel, Mould steel, Stainless steel, Titanium Alloy, Tool steel, and Heat-treated steel processing.
● Main features: Grain size carbon tungsten, high toughness, ALTiN coating, high wear-resistance, special use for high speed cutting of CNC milling machine. Also can increase the smoothness, reduce the rubbing coefficient, and improve the lathe efficiency, save more production time.

极细微粒碳化钨

Micro Grain Carbide



600二刃、四刃平底刀
600 2/4 Flutes Flat End Mill

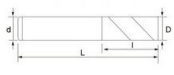

● 适合加工：铜、铝、镁、钛、镍、不锈钢、模具钢、钛合金、工具钢、热作模具钢。
● 主要特性：超微粒碳化钨涂层材料，超厚ALTiN涂层，耐磨，非一般涂层，专用于CNC机床高速切削，能增加寿命，提高生产率，减少换刀次数，提高机床效率，节省工件制作时间。

● Suitable for copper, Cast iron, Carbon steel, Mould steel, Stainless steel, Titanium Alloy, Tool steel, and Heat-treated steel processing.
● Main features: Grain size carbon tungsten, high toughness, ALTiN coating, high wear-resistance, special use for high speed cutting of CNC milling machine. Also can increase the smoothness, reduce the rubbing coefficient, and improve the lathe efficiency, save more production time.

产品编号 Item Code	刃径(D) Outside Diameter	柄径(d) Shank Diameter	刃长(l) Flute Length	全长(L) Overall Length
BFL-MD-010	1.0	4	3	50
BFL-MD-015	1.5	4	4	50
BFL-MD-020	2.0	4	6	50
BFL-MD-025	2.5	4	8	50
BFL-MD-030	3.0	3	8	50
BFL-MD-031	3.0	4	8	50
BFL-MD-035	3.5	4	11	50
BFL-MD-040	4.0	4	11	50
BFL-MD-041	4.0	6	3	50
BFL-MD-042	4.0	6	4	50
BFL-MD-043	4.0	6	5	50
BFL-MD-044	4.0	6	6	50
BFL-MD-045	4.0	6	7	50
BFL-MD-046	4.0	6	8	50
BFL-MD-047	4.0	6	9	50
BFL-MD-048	4.0	6	10	50
BFL-MD-049	4.0	6	11	50
BFL-MD-050	4.0	6	1	



极细微粒碳化钨
Micro Grain Carbide



600二刃、四刃球刀
600 2/4 Flutes Ball Nose End Mill

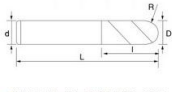

● 适合加工：钢、铸钢、硬钢、模具钢、不锈钢、钛合金、工具钢、热处理钢。
● 主要特性：超细微粒碳化钨材料制造，被覆ALTiN氮化钨涂层，耐磨性、抗氧化性强，适用于CNC高速铣削。能增加光洁度，减少摩擦系数，减少换刀次数，提高机床效率，节省工件制作时间。
● Suitable for copper, Cast Iron, Carbon steel, Mould steel, Stainless steel, Titanium Alloy, Tool steel, and Heat-treated steel processing.
● Main features: Grain size carbon tungsten, high toughness, ALTiN coating, high wear-resistance, special use for high speed cutting of CNC milling machine. Also can increase the smoothness, reduce the rubbing coefficient, and improve the lathe efficiency, save more production time.

产品编号 Item Code	刃径(D) Outside Diameter	柄径(d) Shank Diameter	刃长(l) Flute Length	全长(L) Overall Length
BFL-MR-010	R0.5	4	2	50
BFL-MR-015	R0.75	4	3	50
BFL-MR-020	R1	4	4	50
BFL-MR-025	R1.25	4	5	50
BFL-MR-030	R1.5	3	6	50
BFL-MR-031	R1.5	4	6	50
BFL-MR-040	R2	4	8	50
BFL-MR-010	R0.5	6	2	50
BFL-MR-615	R0.75	6	3	50
BFL-MR-620	R1	6	4	50
BFL-MR-625	R1.25	6	5	50
BFL-MR-630	R1.5	6	6	50
BFL-MR-640	R2	6	8	50
BFL-MR-650	R2.5	5	10	50
BFL-MR-651	R2.5	6	10	50
BFL-MR-660	R3	6	12	50
BFL-MR-080	R4	8	16	60
BFL-MR-100	R5	10	20	75
BFL-MR-120	R6	12	25	75
BFL-MR-160	R8	16	30	100
BFL-MR-200	R10	20	30	100

加长型 Extra Length Type

产品编号 Item Code	刃径(D) Outside Diameter	柄径(d) Shank Diameter	刃长(l) Flute Length	全长(L) Overall Length
BFL-LMR-040	R2	4	8	75
BFL-LMR-041	R2	4	8	100
BFL-LMR-050	R2.5	6	10	75
BFL-LMR-060	R3	6	12	75
BFL-LMR-061	R3	6	12	100
BFL-LMR-062	R3	6	30	150
BFL-LMR-080	R4	8	16	75
BFL-LMR-081	R4	8	16	100
BFL-LMR-082	R4	8	30	150
BFL-LMR-100	R5	10	20	100
BFL-LMR-101	R5	10	40	150
BFL-LMR-120	R6	12	25	100
BFL-LMR-121	R6	12	40	150
BFL-LMR-140	R7	14	40	150
BFL-LMR-160	R8	16	40	150
BFL-LMR-180	R9	18	40	150
BFL-LMR-200	R10	20	40	150



超细微粒碳化钨
Micro Grain Carbide



650二刃、四刃平底刀
650 2/4 Flutes Flat End Mill

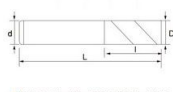

● 适合加工：钢、铸钢、硬钢、模具钢、不锈钢、钛合金、工具钢、热处理钢。
● 主要特性：超细微粒碳化钨材料制造，被覆ALTiN氮化钨涂层，耐磨性、抗氧化性强，适用于CNC高速铣削。能增加光洁度，减少摩擦系数，减少换刀次数，提高机床效率，节省工件制作时间。
● Suitable for copper, Cast Iron, Carbon steel, Mould steel, Stainless steel, Titanium Alloy, Tool steel, and Heat-treated steel processing.
● Main features: Grain size carbon tungsten, high toughness, ALTiN coating, high wear-resistance, special use for high speed cutting of CNC milling machine. Also can increase the smoothness, reduce the rubbing coefficient, and improve the lathe efficiency, save more production time.

产品编号 Item Code	刃径(D) Outside Diameter	柄径(d) Shank Diameter	刃长(l) Flute Length	全长(L) Overall Length
BFL-LD-010	1.0	4	3	50
BFL-LD-015	1.5	4	4	50
BFL-LD-020	2.0	4	4	50
BFL-LD-025	2.5	4	8	50
BFL-LD-030	3.0	3	8	50
BFL-LD-031	3.0	4	8	50
BFL-LD-035	3.5	4	11	50
BFL-LD-040	4.0	4	11	50
BFL-LD-610	1.0	6	3	50
BFL-LD-615	1.5	6	4	50
BFL-LD-620	2.0	6	6	50
BFL-LD-625	2.5	6	8	50
BFL-LD-630	3.0	6	8	50
BFL-LD-635	3.5	6	11	50
BFL-LD-640	4.0	6	11	50
BFL-LD-645	4.5	6	13	50
BFL-LD-650	5.0	5	13	50
BFL-LD-651	5.0	6	13	50
BFL-LD-660	6.0	6	15	50
BFL-LD-070	7.0	8	20	60
BFL-LD-080	8.0	8	20	60
BFL-LD-090	9.0	10	25	75
BFL-LD-100	10.0	10	25	75
BFL-LD-120	12.0	12	30	75
BFL-LD-140	14.0	14	45	100
BFL-LD-160	16.0	16	45	100
BFL-LD-180	18.0	18	45	100
BFL-LD-200	20.0	20	45	100

加长型 Extra Length Type

产品编号 Item Code	刃径(D) Outside Diameter	柄径(d) Shank Diameter	刃长(l) Flute Length	全长(L) Overall Length
BFL-LLD-040	4.0	4	11	75
BFL-LLD-041	4.0	4	11	100
BFL-LLD-050	5.0	6	13	75
BFL-LLD-060	6.0	6	15	75
BFL-LLD-061	6.0	6	15	100
BFL-LLD-062	6.0	6	40	150
BFL-LLD-080	8.0	8	20	75
BFL-LLD-081	8.0	8	20	100
BFL-LLD-082	8.0	8	40	150
BFL-LLD-100	10.0	10	25	100
BFL-LLD-101	10.0	10	50	150
BFL-LLD-120	12.0	12	30	100
BFL-LLD-121	12.0	12	50	150
BFL-LLD-140	14.0	14	50	150
BFL-LLD-160	16.0	16	50	150
BFL-LLD-180	18.0	18	50	150
BFL-LLD-200	20.0	20	50	150



超细微粒碳化钨
Micro Grain Carbide



650二刃、四刃球刀
650 2/4 Flutes Ball Nose End Mill

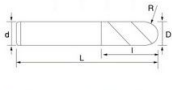

● 适合加工：钢、铸钢、硬钢、模具钢、不锈钢、钛合金、工具钢、热处理钢。
● 主要特性：超细微粒碳化钨材料制造，被覆ALTiN氮化钨涂层，耐磨性、抗氧化性强，适用于CNC高速铣削。能增加光洁度，减少摩擦系数，减少换刀次数，提高机床效率，节省工件制作时间。
● Suitable for copper, Cast Iron, Carbon steel, Mould steel, Stainless steel, Titanium Alloy, Tool steel, and Heat-treated steel processing.
● Main features: Grain size carbon tungsten, high toughness, ALTiN coating, high wear-resistance, special use for high speed cutting of CNC milling machine. Also can increase the smoothness, reduce the rubbing coefficient, and improve the lathe efficiency, save more production time.

产品编号 Item Code	刃径(D) Outside Diameter	柄径(d) Shank Diameter	刃长(l) Flute Length	全长(L) Overall Length
BFL-LR-010	R0.5	4	2	50
BFL-LR-015	R0.75	4	3	50
BFL-LR-020	R1	4	4	50
BFL-LR-025	R1.25	4	5	50
BFL-LR-030	R1.5	3	6	50
BFL-LR-031	R1.5	4	6	50
BFL-LR-040	R2	4	8	50
BFL-LR-610	R0.5	6	2	50
BFL-LR-615	R0.75	6	3	50
BFL-LR-620	R1	6	4	50
BFL-LR-625	R1.25	6	5	50
BFL-LR-630	R1.5	6	6	50
BFL-LR-640	R2	6	8	50
BFL-LR-650	R2.5	5	10	50
BFL-LR-651	R2.5	6	10	50
BFL-LR-660	R3	6	12	50
BFL-LR-080	R4	8	16	60
BFL-LR-100	R5	10	20	75
BFL-LR-120	R6	12	25	75
BFL-LR-160	R8	16	30	100
BFL-LR-200	R10	20	30	100

加长型 Extra Length Type

产品编号 Item Code	刃径(D) Outside Diameter	柄径(d) Shank Diameter	刃长(l) Flute Length	全长(L) Overall Length
BFL-LLR-040	R2	4	8	75
BFL-LLR-041	R2	4	8	100
BFL-LLR-050	R2.5	6	10	75
BFL-LLR-060	R3	6	12	75
BFL-LLR-061	R3	6	12	100
BFL-LLR-062	R3	6	30	150
BFL-LLR-080	R4	8	16	75
BFL-LLR-081	R4	8	16	100
BFL-LLR-082	R4	8	30	150
BFL-LLR-100	R5	10	20	100
BFL-LLR-101	R5	10	40	150
BFL-LLR-120	R6	12	25	100
BFL-LLR-121	R6	12	40	150
BFL-LLR-140	R7	14	40	150
BFL-LLR-160	R8	16	40	150
BFL-LLR-180	R9	18	40	150
BFL-LLR-200	R10	20	40	150



超细微粒碳化钨
Micro Grain Carbide



450二刃、四刃圆鼻刀
450 2/4 Flutes Corner Radius End Mill



● 适合加工：钢、铸钢、硬钢、模具钢。
● 主要特性：超细微粒碳化钨材料制造，被覆ALTiN氮化钨涂层，耐磨性、抗氧化性强，适用于CNC高速铣削。能增加光洁度，减少摩擦系数，减少换刀次数，提高机床效率，节省工件制作时间。
● Suitable for Copper, Cast Iron, Carbon steel, and Mould steel processing.
● Main features: Grain size carbon tungsten, high toughness, ALTiN coating, high wear-resistance, special use for high speed cutting of CNC milling machine. Also can increase the smoothness, reduce the rubbing coefficient, and improve the lathe efficiency, save more production time.

产品编号 Item Code	刃径(D) Outside Diameter	R6(R) Radius	柄径(d) Shank Diameter	刃长(l) Flute Length	全长(L) Overall Length
BFL-ER-020-05	2.0	R0.5	4	4	50
BFL-ER-030-05	3.0	R0.5	4	5	50
BFL-ER-040-05	4.0	R0.5	4	8	50
BFL-ER-040-10	4.0	R1	4	8	50
BFL-ER-060-05	6.0	R0.5	6	12	50
BFL-ER-060-10	6.0	R1	6	12	50
BFL-ER-080-05	8.0	R0.5	8	16	60
BFL-ER-080-10	8.0	R1	8	16	60
BFL-ER-080-15	8.0	R1.5	8	16	60
BFL-ER-100-05	10.0	R0.5	10	20	75
BFL-ER-100-10	10.0	R1	10	20	75
BFL-ER-100-15	10.0	R1.5	10	20	75
BFL-ER-120-05	12.0	R0.5	12	24	75
BFL-ER-120-10	12.0	R1	12	24	75
BFL-ER-120-15	12.0	R1.5	12	24	75
BFL-ER-120-20	12.0	R2	12	24	75

加长型 Extra Length Type

产品编号 Item Code	刃径(D) Outside Diameter	R6(R) Radius	柄径(d) Shank Diameter	刃长(l) Flute Length	全长(L) Overall Length
BFL-LER-020-05	2.0	R0.5	4	4	75
BFL-LER-030-05	3.0	R0.5	4	5	75
BFL-LER-040-05	4.0	R0.5	4	8	75
BFL-LER-040-10	4.0	R1	4	8	75
BFL-LER-140-05	4.0	R0.5	4	8	100
BFL-LER-140-10	4.0	R1	4	8	100
BFL-LER-060-05	6.0	R0.5	6	12	75
BFL-LER-060-10	6.0	R1	6	12	75
BFL-LER-160-05	6.0	R0.5	6	12	100
BFL-LER-160-10	6.0	R1	6	12	100
BFL-LER-080-05	8.0	R0.5	8	16	75
BFL-LER-080-10	8.0	R1	8	16	75
BFL-LER-080-15	8.0	R1.5	8	16	75
BFL-LER-100-05	10.0	R0.5	10	20	100
BFL-LER-100-10	10.0	R1	10	20	100
BFL-LER-100-15	10.0	R1.5	10	20	100
BFL-LER-120-05	12.0	R0.5	12	24	100
BFL-LER-120-10	12.0	R1	12	24	100
BFL-LER-120-15	12.0	R1.5	12	24	100
BFL-LER-120-20	12.0	R2	12	24	100

极细微粒碳化钨
Micro Grain Carbide**550二刃、四刃圆鼻刀**
550 2/4 Flutes Corner Radius End Mill

非标准可接受定制



● 适合加工：钢、铸钢、硬钢、镍基合金、不锈钢、钛合金、工具钢、热处理钢。
 ● 主要特点：极细微粒碳化钨材料特性，镀覆ALTiN氮化钨涂层，耐磨性、热稳定性、高韧性、ALTiN涂层，高耐磨性，适用于CNC高速切削，能减少摩擦，减少切削力，减少换刀次数，提高机床效率，节省工件制作时间。
 ● Suitable for copper, Cast Iron, Carbon steel, Mould steel, Stainless steel, Titanium Alloy, Tool steel, and Heat-treated steel processing.
 ● Main features: Grain size carbon tungsten, high toughness, ALTiN coating, high wear-resistance, special use for high speed cutting of CNC milling machine. Also can increase the smoothness, reduce the rubbing coefficient, and improve the lathe efficiency, save more production time.

产品编号 Item Code	刃径(D) Outside Diameter	R径(R) Radius	柄径(d) Shank Diameter	刃长(l) Flute Length	全长(L) Overall Length
BFL-AR-020-05	2.0	R0.5	4	4	50
BFL-AR-030-05	3.0	R0.5	4	5	50
BFL-AR-040-05	4.0	R0.5	4	8	50
BFL-AR-040-10	4.0	R1	4	8	50
BFL-AR-060-05	6.0	R0.5	6	12	50
BFL-AR-060-10	6.0	R1	6	12	50
BFL-AR-080-05	8.0	R0.5	8	16	60
BFL-AR-080-10	8.0	R1	8	16	60
BFL-AR-100-05	10.0	R0.5	10	20	75
BFL-AR-100-10	10.0	R1	10	20	75
BFL-AR-100-15	10.0	R1.5	10	20	75
BFL-AR-120-05	12.0	R0.5	12	24	75
BFL-AR-120-10	12.0	R1	12	24	75
BFL-AR-120-15	12.0	R1.5	12	24	75
BFL-AR-120-20	12.0	R2	12	24	75

加长型 Extra Length Type

产品编号 Item Code	刃径(D) Outside Diameter	R径(R) Radius	柄径(d) Shank Diameter	刃长(l) Flute Length	全长(L) Overall Length
BFL-LAR-020-05	2.0	R0.5	4	4	75
BFL-LAR-030-05	3.0	R0.5	4	5	75
BFL-LAR-040-05	4.0	R0.5	4	8	75
BFL-LAR-040-10	4.0	R1	4	8	75
BFL-LAR-140-05	4.0	R0.5	4	8	100
BFL-LAR-140-10	4.0	R1	4	8	100
BFL-LAR-060-05	6.0	R0.5	6	12	75
BFL-LAR-060-10	6.0	R1	6	12	75
BFL-LAR-080-05	8.0	R0.5	8	12	100
BFL-LAR-080-10	8.0	R1	8	12	100
BFL-LAR-080-15	8.0	R1.5	8	16	75
BFL-LAR-100-05	10.0	R0.5	10	20	100
BFL-LAR-100-10	10.0	R1	10	20	100
BFL-LAR-100-15	10.0	R1.5	10	20	100
BFL-LAR-120-05	12.0	R0.5	12	24	100
BFL-LAR-120-10	12.0	R1	12	24	100
BFL-LAR-120-15	12.0	R1.5	12	24	100
BFL-LAR-120-20	12.0	R2	12	24	100

极细微粒碳化钨
Micro Grain Carbide**600二刃、四刃圆鼻刀**
600 2/4 Flutes Corner Radius End Mill

非标准可接受定制



● 适合加工：钢、铸钢、硬钢、镍基合金、不锈钢、钛合金、工具钢、热处理钢。
 ● 主要特点：极细微粒碳化钨材料特性，镀覆ALTiN氮化钨涂层，耐磨性、热稳定性、高韧性、ALTiN涂层，高耐磨性，适用于CNC高速切削，能减少摩擦，减少切削力，减少换刀次数，提高机床效率，节省工件制作时间。
 ● Suitable for copper, Cast Iron, Carbon steel, Mould steel, Stainless steel, Titanium Alloy, Tool steel, and Heat-treated steel processing.
 ● Main features: Grain size carbon tungsten, high toughness, ALTiN coating, high wear-resistance, special use for high speed cutting of CNC milling machine. Also can increase the smoothness, reduce the rubbing coefficient, and improve the lathe efficiency, save more production time.

产品编号 Item Code	刃径(D) Outside Diameter	R径(R) Radius	柄径(d) Shank Diameter	刃长(l) Flute Length	全长(L) Overall Length
BFL-MR-020-05	2.0	R0.5	4	4	50
BFL-MR-030-05	3.0	R0.5	4	5	50
BFL-MR-040-05	4.0	R0.5	4	8	50
BFL-MR-040-10	4.0	R1	4	8	50
BFL-MR-060-05	6.0	R0.5	6	12	50
BFL-MR-060-10	6.0	R1	6	12	50
BFL-MR-080-05	8.0	R0.5	8	16	60
BFL-MR-080-10	8.0	R1	8	16	60
BFL-MR-080-15	8.0	R1.5	8	16	60
BFL-MR-100-05	10.0	R0.5	10	20	75
BFL-MR-100-10	10.0	R1	10	20	75
BFL-MR-100-15	10.0	R1.5	10	20	75
BFL-MR-120-05	12.0	R0.5	12	24	75
BFL-MR-120-10	12.0	R1	12	24	75
BFL-MR-120-15	12.0	R1.5	12	24	75
BFL-MR-120-20	12.0	R2	12	24	75

加长型 Extra Length Type

产品编号 Item Code	刃径(D) Outside Diameter	R径(R) Radius	柄径(d) Shank Diameter	刃长(l) Flute Length	全长(L) Overall Length
BFL-LMR-020-05	2.0	R0.5	4	4	75
BFL-LMR-030-05	3.0	R0.5	4	5	75
BFL-LMR-040-05	4.0	R0.5	4	8	75
BFL-LMR-040-10	4.0	R1	4	8	75
BFL-LMR-140-05	4.0	R0.5	4	8	100
BFL-LMR-140-10	4.0	R1	4	8	100
BFL-LMR-060-05	6.0	R0.5	6	12	75
BFL-LMR-060-10	6.0	R1	6	12	75
BFL-LMR-080-05	8.0	R0.5	8	12	100
BFL-LMR-080-10	8.0	R1	8	12	100
BFL-LMR-080-15	8.0	R1.5	8	16	75
BFL-LMR-100-05	10.0	R0.5	10	20	100
BFL-LMR-100-10	10.0	R1	10	20	100
BFL-LMR-100-15	10.0	R1.5	10	20	100
BFL-LMR-120-05	12.0	R0.5	12	24	100
BFL-LMR-120-10	12.0	R1	12	24	100
BFL-LMR-120-15	12.0	R1.5	12	24	100
BFL-LMR-120-20	12.0	R2	12	24	100

细(极细)微粒碳化钨
Micro Grain Carbide**500/600 铝用二刃、三刃55°**
500/600 2/3 Flutes Aluminum Processing End Mills 55°

● 适合加工：钢、铸、合金钢、合金铜、镍合金、钛合金、铝铜。

● Suitable for Copper, Aluminum, Aluminum alloy, Copper alloy, Nickel alloy, Titanium alloy and Plastic processing.

产品编号 Item Code	刃径(D) Outside Diameter	柄径(d) Shank Diameter	刃长(l) Flute Length	全长(L) Overall Length
BFL-AEA-010	1.0	4	3	50
BFL-AEA-015	1.5	4	4	50
BFL-AEA-020	2.0	4	6	50
BFL-AEA-025	2.5	4	8	50
BFL-AEA-030	3.0	4	8	50
BFL-AEA-040	4.0	4	11	50
BFL-AEA-050	5.0	6	13	50
BFL-AEA-060	6.0	6	15	50
BFL-AEA-080	8.0	8	20	60
BFL-AEA-100	10.0	10	25	75
BFL-AEA-120	12.0	12	30	75
BFL-AEA-140	14.0	14	45	100
BFL-AEA-160	16.0	16	45	100
BFL-AEA-180	18.0	18	45	100
BFL-AEA-200	20.0	20	45	100

加长型 Extra Length Type

产品编号 Item Code	刃径(D) Outside Diameter	柄径(d) Shank Diameter	刃长(l) Flute Length	全长(L) Overall Length
BFL-AEB-030	3.0	4	11	75
BFL-AEB-040	4.0	4	11	75
BFL-AEB-041	4.0	4	11	100
BFL-AEB-050	5.0	6	13	75
BFL-AEB-060	6.0	6	15	75
BFL-AEB-061	6.0	6	15	100
BFL-AEB-062	6.0	6	15	150
BFL-AEB-080	8.0	8	20	75
BFL-AEB-081	8.0	8	20	100
BFL-AEB-082	8.0	8	20	150
BFL-AEB-100	10.0	10	25	100
BFL-AEB-101	10.0	10	25	150
BFL-AEB-120	12.0	12	30	100
BFL-AEB-121	12.0	12	30	150
BFL-AEB-140	14.0	14	50	150
BFL-AEB-160	16.0	16	50	150
BFL-AEB-180	18.0	18	50	150
BFL-AEB-200	20.0	20	50	150

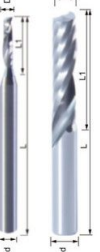
单刃螺旋铣刀
One Spiral Flute Bits

产品编号 Item Code	刃径(D) Outside Diameter	柄径(d) Shank Diameter	刃长(l) Flute Length	全长(L) Overall Length	产品编号 Item Code	刃径(D) Outside Diameter	柄径(d) Shank Diameter	刃长(l) Flute Length	全长(L) Overall Length
BFL-BEB-010	1	3	1.75	38.5	BFL-BEB-041	4	15	4	40
BFL-BEB-011	1	6	1.75	38.5	BFL-BEB-042	4	17	4	40
BFL-BEB-012	1.2	6	1.75	38.5	BFL-BEB-043	4	22	4	45
BFL-BEB-013	1.2	10	1.75	38.5	BFL-BEB-044	4	25	4	50
BFL-BEB-015	1.5	8	1.75	38.5	BFL-BEB-045	4	28	4	50
BFL-BEB-016	1.5	12	1.75	38.5	BFL-BEB-046	4	32	4	60
BFL-BEB-020	2	8	1.75	38.5	BFL-BEB-047	4	42	4	70
BFL-BEB-021	2	12	1.75	38.5	BFL-BEB-048	4	52	4	80
BFL-BEB-022	2	15	1.75	38.5	BFL-BEB-050	5	17	4	50
BFL-BEB-023	2	17	1.75	45	BFL-BEB-050	5	22	5	50
BFL-BEB-024	2	22	1.75	45	BFL-BEB-051	5	32	5	60
BFL-BEB-025	2.5	12	1.75	38.5	BFL-BEB-130	12	12	6	50
BFL-BEB-026	2.5	15	1.75	38.5	BFL-BEB-131	3	17	6	50
BFL-BEB-027	2.5	22	1.75	45	BFL-BEB-140	4	17	6	50
BFL-BEB-3175	3.175	6	3.175	38.5	BFL-BEB-141	4	22	6	60
BFL-BEB-3176	3.175	8	3.175	38.5	BFL-BEB-150	5	22	6	50
BFL-BEB-3177	3.175	12	3.175	38.5	BFL-BEB-151	5	25	6	55
BFL-BEB-3178	3.175	15	3.175	38.5	BFL-BEB-060	6	17	6	50
BFL-BEB-3179	3.175	17	3.175	38.5	BFL-BEB-061	6	22	6	50
BFL-BEB-3180	3.175	22	3.175	45	BFL-BEB-062	6	25	6	50
BFL-BEB-3181	3.175	25	3.175	50	BFL-BEB-063	6	32	6	60
BFL-BEB-3182	3.175	28	3.175	50	BFL-BEB-064	6	42	6	70
BFL-BEB-3183	3.175	32	3.175	60	BFL-BEB-065	6	52	6	80
BFL-BEB-3184	3.175	42	3.175	70	BFL-BEB-080	8	32	8	80
BFL-BEB-030	3	12	4	50	BFL-BEB-100	10	32	10	80
BFL-BEB-031	3	15	4	50	BFL-BEB-120	12	32	12	80
BFL-BEB-032	3	17	4	50	BFL-BEB-140	14	32	14	100
BFL-BEB-033	3	22	4	50	BFL-BEB-141	14	42	14	100
BFL-BEB-040	4	12	4	40					

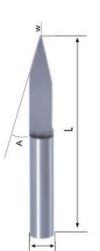
单刃锥度雕刻刀
Flat Bottom Engraving Bits

产品编号 Item Code	刀宽 (W)	刃径 (d)	柄径 (D)	柄长 (L)	产品编号 Item Code	刀宽 (W)	刃径 (d)	柄径 (D)	柄长 (L)
BFL-FBE-0010	0.1	10	3.175	38.5	BFL-FBE-0960	0.6	30	4	40
BFL-FBE-0020	0.2	10	3.175	38.5	BFL-FBE-0980	0.8	30	4	40
BFL-FBE-0030	0.3	10	3.175	38.5	BFL-FBE-1010	0.1	45	4	40
BFL-FBE-0110	0.1	15	3.175	38.5	BFL-FBE-1020	0.2	45	4	40
BFL-FBE-0120	0.2	15	3.175	38.5	BFL-FBE-1030	0.3	45	4	40
BFL-FBE-0130	0.3	15	3.175	38.5	BFL-FBE-1040	0.4	45	4	40
BFL-FBE-0110	0.1	20	3.175	38.5	BFL-FBE-1050	0.5	45	4	40
BFL-FBE-0210	0.1	20	3.175	38.5	BFL-FBE-1110	0.1	60	4	40
BFL-FBE-0220	0.2	20	3.175	38.5	BFL-FBE-1120	0.2	60	4	40
BFL-FBE-0230	0.3	20	3.175	38.5	BFL-FBE-1130	0.3	60	4	40
BFL-FBE-0240	0.4	20	3.175	38.5	BFL-FBE-1140	0.4	60		

极细微粒碳化钨
Micro GrainCarbide

产品编号 Item Code	刃径(D) Outside Diameter	柄径(d) Shank Diameter	刃长(l) Flute Length	全长(L) Overall Length
BFL-EMD-060	6.0	6	15	50
BFL-EMD-080	8.0	8	20	60
BFL-EMD-100	10.0	10	25	75
BFL-EMD-120	12.0	12	30	75
BFL-EMD-160	16.0	16	40	100
BFL-EMD-200	20.0	20	40	100
BFL-EMD-250	25.0	25	40	100



六刃精铣刀
6 Flutes Finishing End Mill

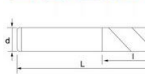

● 适合加工：铜、铝、镁、钛、镍、钴、镍基合金、不锈钢、钛合金、工具钢、热处理钢。
● 主要特性：极细微粒碳化钨材料特性，被覆 ALTiN 氮化钨涂层，耐磨性、每一微米的刃长，专用于 CNC 机床高速切削，能增加光洁度，降低摩擦系数，减少换刀次数，提高机床效率，节省工件制作时间。
● Suitable for copper, Cast Iron, Carbon steel, Mould steel, Stainless steel, Titanium Alloy, Tool steel, and Heat-treated steel processing.
● Main features: Grain size carbon tungsten, high toughness, ALTiN coating, high wear-resistance, special use for high speed cutting of CNC milling machine. Also can increase the smoothness, reduce the rubbing coefficient, and improve the lathe efficiency, save more production time.

极细微粒碳化钨
Micro GrainCarbide

产品编号 Item Code	刃径(D) Outside Diameter	柄径(d) Shank Diameter	刃长(l) Flute Length	全长(L) Overall Length
BFL-DA-060	6.0	6	15	50
BFL-DA-080	8.0	8	20	60
BFL-DA-100	10.0	10	25	75
BFL-DA-120	12.0	12	30	75
BFL-DA-140	14.0	14	45	100
BFL-DA-160	16.0	16	45	100
BFL-DA-180	18.0	18	45	100
BFL-DA-200	20.0	20	45	100



三刃、四刃粗皮刀
3/4 Flutes Roughing End Mill

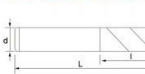

● 适合加工：铜、铝、镁、钛、镍、钴、镍基合金、不锈钢、钛合金、工具钢、热处理钢。
● 主要特性：极细微粒碳化钨材料特性，被覆 ALTiN 氮化钨涂层，耐磨性、每一微米的刃长，专用于 CNC 机床高速切削，能增加光洁度，降低摩擦系数，减少换刀次数，提高机床效率，节省工件制作时间。
● Suitable for copper, Cast Iron, Carbon steel, Mould steel, Stainless steel, Titanium Alloy, Tool steel, and Heat-treated steel processing.
● Main features: Grain size carbon tungsten, high toughness, ALTiN coating, high wear-resistance, special use for high speed cutting of CNC milling machine. Also can increase the smoothness, reduce the rubbing coefficient, and improve the lathe efficiency, save more production time.

加长型 Extra Length Type

产品编号 Item Code	刃径(D) Outside Diameter	柄径(d) Shank Diameter	刃长(l) Flute Length	全长(L) Overall Length
BFL-LDA-060	6.0	6	15	75
BFL-LDA-061	6.0	6	15	100
BFL-LDA-062	6.0	6	15	150
BFL-LDA-080	8.0	8	20	75
BFL-LDA-081	8.0	8	20	100
BFL-LDA-082	8.0	8	20	150
BFL-LDA-100	10.0	10	25	100
BFL-LDA-101	10.0	10	25	150
BFL-LDA-120	12.0	12	30	100
BFL-LDA-121	12.0	12	30	150
BFL-LDA-140	14.0	14	45	150
BFL-LDA-160	16.0	16	50	150
BFL-LDA-180	18.0	18	55	150
BFL-LDA-200	20.0	20	60	150

极细微粒碳化钨
Micro GrainCarbide

产品编号 Item Code	先端径(D1) Tip For Diameter	刃长(l) Flute Length	倾角(α) Flute Length	球径(D2) Overall Length	全长(L) Overall Length	柄径(d) Overall Length
BFL-FT-030-01	3.0	10	0.5°	3.17	50	4
BFL-FT-030-02	3.0	10	1.0°	3.35	50	4
BFL-FT-030-03	3.0	10	1.5°	3.52	50	4
BFL-FT-030-04	3.0	10	2.0°	3.07	50	4
BFL-FT-030-06	3.0	10	3.0°	4.05	50	6
BFL-FT-030-08	3.0	10	4.0°	4.05	50	6
BFL-FT-030-10	3.0	10	5.0°	4.75	50	6
BFL-FT-040-01	4.0	15	0.5°	4.26	50	6
BFL-FT-040-02	4.0	15	1.0°	4.52	50	6
BFL-FT-040-03	4.0	15	1.5°	4.79	50	6
BFL-FT-040-04	4.0	15	2.0°	5.05	50	6
BFL-FT-040-06	4.0	15	3.0°	5.57	50	6
BFL-FT-040-08	4.0	15	4.0°	5.57	60	8
BFL-FT-040-10	4.0	15	5.0°	6.62	60	8
BFL-FT-050-01	5.0	20	0.5°	5.35	60	6
BFL-FT-050-02	5.0	20	1.0°	5.70	60	6
BFL-FT-050-03	5.0	20	1.5°	6.05	60	8
BFL-FT-050-04	5.0	20	2.0°	6.40	60	8
BFL-FT-050-06	5.0	20	3.0°	7.10	60	8
BFL-FT-050-08	5.0	20	4.0°	7.10	60	10
BFL-FT-050-10	5.0	20	5.0°	8.50	60	10
BFL-FT-060-01	6.0	20	0.5°	6.35	60	8
BFL-FT-060-02	6.0	20	1.0°	6.70	60	8
BFL-FT-060-03	6.0	20	1.5°	7.05	60	8
BFL-FT-060-04	6.0	20	2.0°	7.40	60	8
BFL-FT-060-06	6.0	20	3.0°	8.10	75	10
BFL-FT-060-08	6.0	20	4.0°	8.10	75	10
BFL-FT-060-10	6.0	20	5.0°	9.50	75	10
BFL-FT-080-01	8.0	25	0.5°	8.44	75	10
BFL-FT-080-02	8.0	25	1.0°	8.87	75	10
BFL-FT-080-03	8.0	25	1.5°	9.31	75	10
BFL-FT-080-04	8.0	25	2.0°	9.75	75	10
BFL-FT-080-06	8.0	25	3.0°	10.62	75	12
BFL-FT-080-08	8.0	25	4.0°	10.62	75	12
BFL-FT-080-10	8.0	25	5.0°	12.37	75	12
BFL-FT-100-01	10.0	25	0.5°	10.61	100	12
BFL-FT-100-02	10.0	25	1.0°	11.22	100	12
BFL-FT-100-03	10.0	25	1.5°	11.83	100	12
BFL-FT-100-04	10.0	25	2.0°	12.44	100	12
BFL-FT-100-06	10.0	25	3.0°	13.67	100	12
BFL-FT-100-08	10.0	25	4.0°	13.67	100	16
BFL-FT-100-10	10.0	34.2	5.0°	16.00	100	16



二刃、四刃球头刀
2/4 Flutes Taper Ball Nose End Mill

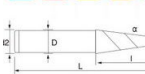

● 适合加工：铜、铝、镁、钛、镍、钴、镍基合金、不锈钢、钛合金、工具钢、热处理钢。
● 主要特性：极细微粒碳化钨材料特性，被覆 ALTiN 氮化钨涂层，耐磨性、每一微米的刃长，专用于 CNC 机床高速切削，能增加光洁度，降低摩擦系数，减少换刀次数，提高机床效率，节省工件制作时间。
● Suitable for copper, Cast Iron, Carbon steel, Mould steel, Stainless steel, Titanium Alloy, Tool steel, and Heat-treated steel processing.
● Main features: Grain size carbon tungsten, high toughness, ALTiN coating, high wear-resistance, special use for high speed cutting of CNC milling machine. Also can increase the smoothness, reduce the rubbing coefficient, and improve the lathe efficiency, save more production time.

极细微粒碳化钨
Micro GrainCarbide

产品编号 Item Code	先端径(D1) Tip For Diameter	刃长(l) Flute Length	倾角(α) Flute Length	球径(D2) Overall Length	全长(L) Overall Length	柄径(d) Overall Length
BFL-RT-030-01	R1.5	20	0.5°	3.32	60	4
BFL-RT-030-02	R1.5	20	1.0°	3.65	60	4
BFL-RT-030-03	R1.5	20	1.5°	3.97	60	4
BFL-RT-030-04	R1.5	20	2.0°	4.29	60	4
BFL-RT-030-06	R1.5	20	3.0°	4.94	60	6
BFL-RT-030-08	R1.5	20	4.0°	5.60	60	6
BFL-RT-030-10	R1.5	20	5.0°	6.25	60	6
BFL-RT-040-01	R2.0	25	0.5°	4.40	75	6
BFL-RT-040-02	R2.0	25	1.0°	4.80	75	6
BFL-RT-040-03	R2.0	25	1.5°	5.21	75	6
BFL-RT-040-04	R2.0	25	2.0°	5.61	75	6
BFL-RT-040-06	R2.0	25	3.0°	6.42	75	6
BFL-RT-040-08	R2.0	25	4.0°	7.23	75	8
BFL-RT-040-10	R2.0	25	5.0°	8.04	75	8
BFL-RT-050-01	R2.5	30	0.5°	5.48	75	6
BFL-RT-050-02	R2.5	30	1.0°	5.96	75	6
BFL-RT-050-03	R2.5	30	1.5°	6.44	75	8
BFL-RT-050-04	R2.5	30	2.0°	6.92	75	8
BFL-RT-050-06	R2.5	30	3.0°	7.89	75	8
BFL-RT-050-08	R2.5	30	4.0°	8.86	75	10
BFL-RT-050-10	R2.5	30	5.0°	9.83	75	10
BFL-RT-060-01	R3.0	35	0.5°	6.56	100	8
BFL-RT-060-02	R3.0	35	1.0°	7.12	100	8
BFL-RT-060-03	R3.0	35	1.5°	7.68	100	8
BFL-RT-060-04	R3.0	35	2.0°	8.24	100	8
BFL-RT-060-06	R3.0	35	3.0°	9.36	100	10
BFL-RT-060-08	R3.0	35	4.0°	10.49	100	12
BFL-RT-060-10	R3.0	35	5.0°	11.62	100	12
BFL-RT-080-01	R4.0	40	0.5°	8.63	100	10
BFL-RT-080-02	R4.0	40	1.0°	9.26	100	10
BFL-RT-080-03	R4.0	40	1.5°	9.89	100	10
BFL-RT-080-04	R4.0	40	2.0°	10.52	100	12
BFL-RT-080-06	R4.0	40	3.0°	11.78	100	12
BFL-RT-080-08	R4.0	40	4.0°	13.05	100	16
BFL-RT-080-10	R4.0	40	5.0°	14.33	100	16
BFL-RT-100-01	R5.0	45	0.5°	10.70	100	12
BFL-RT-100-02	R5.0	45	1.0°	11.40	100	12
BFL-RT-100-03	R5.0	45	1.5°	12.10	100	12
BFL-RT-100-04	R5.0	45	2.0°	12.80	100	16
BFL-RT-100-06	R5.0	45	3.0°	14.20	100	16
BFL-RT-100-08	R5.0	45	4.0°	15.62	100	16
BFL-RT-100-10	R5.0	45	5.0°	17.04	100	20



二刃斜度圆球刀
2 Flutes Taper Ball Nose End Mill

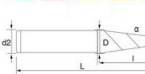

● 适合加工：铜、铝、镁、钛、镍、钴、镍基合金、不锈钢、钛合金、工具钢、热处理钢。
● 主要特性：极细微粒碳化钨材料特性，被覆 ALTiN 氮化钨涂层，耐磨性、每一微米的刃长，专用于 CNC 机床高速切削，能增加光洁度，降低摩擦系数，减少换刀次数，提高机床效率，节省工件制作时间。
● Suitable for copper, Cast Iron, Carbon steel, Mould steel, Stainless steel, Titanium Alloy, Tool steel, and Heat-treated steel processing.
● Main features: Grain size carbon tungsten, high toughness, ALTiN coating, high wear-resistance, special use for high speed cutting of CNC milling machine. Also can increase the smoothness, reduce the rubbing coefficient, and improve the lathe efficiency, save more production time.

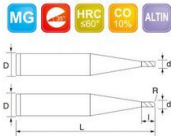
极细微粒碳化钨
Micro Grain Carbide微小径平刀、球刀
Micro-diameter Flat End Mill
And Ball Nose End Mill

● 适合加工：铜、铝、镁、钛、镍、不锈钢、钛合金、玻璃钢、碳纤维等。
● 主要特性：极细微粒碳化钨母材精度高，被覆层 ALTiN 碳化钨涂层，耐磨、抗崩刃、寿命长、精度高、切削力大、减少切削力、提高机床效率、节省工件制作时间。
● Suitable for copper, Cast iron, Carbon steel, Molded steel, Stainless steel, Titanium Alloy, Tool steel, and Heat-treated steel processing.
● Main features: Grain size carbon tangsten, high toughness, ALTiN coating, high wear-resistance, special use for high speed cutting of CNC milling machine. Also can increase the smoothness, reduce the rubbing coefficient, and improve the same efficiency, save more production time.

产品编号 Item Code	刃径(D) Outside Diameter	柄径(d) Shank Diameter	刃长(l) Flute Length	全长(L) Overall Length
BFL-SD-002	0.2	4	0.4	50
BFL-SD-003	0.3	4	0.6	50
BFL-SD-004	0.4	4	0.8	50
BFL-SD-005	0.5	4	1.0	50
BFL-SD-006	0.6	4	1.2	50
BFL-SD-007	0.7	4	1.4	50
BFL-SD-008	0.8	4	1.6	50
BFL-SD-009	0.9	4	1.8	50

产品编号 Item Code	刃径(D) Outside Diameter	柄径(d) Shank Diameter	刃长(l) Flute Length	全长(L) Overall Length
BFL-SR-003	R0.15	4	0.6	50
BFL-SR-004	R0.20	4	0.8	50
BFL-SR-005	R0.25	4	1.0	50
BFL-SR-006	R0.30	4	1.2	50
BFL-SR-007	R0.35	4	1.4	50
BFL-SR-008	R0.40	4	1.6	50
BFL-SR-009	R0.45	4	1.8	50

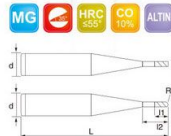
极细微粒碳化钨
Micro Grain Carbide深沟刀
Long Neck Short Flute End Mill

● 适合加工：铜、铝、镁、钛、镍、不锈钢、钛合金、玻璃钢、碳纤维等。
● 主要特性：极细微粒碳化钨母材精度高，被覆层 ALTiN 碳化钨涂层，耐磨、抗崩刃、寿命长、精度高、切削力大、减少切削力、提高机床效率、节省工件制作时间。
● Suitable for copper, Cast iron, Carbon steel, Molded steel, Stainless steel, Titanium Alloy, Tool steel, and Heat-treated steel processing.
● Main features: Grain size carbon tangsten, high toughness, ALTiN coating, high wear-resistance, special use for high speed cutting of CNC milling machine. Also can increase the smoothness, reduce the rubbing coefficient, and improve the same efficiency, save more production time.

产品编号 Item Code	刃径(D) Outside Diameter	刃长(l) Flute Length	柄径(d) Shank Diameter	全长(L) Overall Length	产品编号 Item Code	刃径(D) Outside Diameter	刃长(l) Flute Length	柄径(d) Shank Diameter	全长(L) Overall Length		
BFL-SD-002	0.4	0.6	2	50	4	BFL-SD-016	1.5	1.7	8	50	4
BFL-SD-004	0.4	0.6	4	50	4	BFL-SD-018	1.5	1.7	10	50	4
BFL-SD-005	0.5	0.8	2	50	4	BFL-SD-020	1.5	1.7	12	50	4
BFL-SD-006	0.5	0.8	4	50	4	BFL-SD-022	2.0	2.2	6	50	4
BFL-SD-007	0.5	0.8	6	50	4	BFL-SD-024	2.0	2.2	8	50	4
BFL-SD-008	0.6	1.0	2	50	4	BFL-SD-026	2.0	2.2	10	50	4
BFL-SD-009	0.6	1.0	4	50	4	BFL-SD-028	2.0	2.2	12	50	4
BFL-SD-010	0.6	1.0	6	50	4	BFL-SD-030	2.0	2.2	14	50	4
BFL-SD-011	0.6	1.0	8	50	4	BFL-SD-032	3.0	3.2	10	50	4
BFL-SD-012	0.6	1.0	10	50	4	BFL-SD-034	3.0	3.2	12	50	4
BFL-SD-013	0.6	1.0	12	50	4	BFL-SD-036	3.0	3.2	14	50	4
BFL-SD-014	0.6	1.0	14	50	4	BFL-SD-038	3.0	3.2	16	75	4
BFL-SD-015	0.6	1.0	16	50	4	BFL-SD-040	3.0	3.2	20	75	6
BFL-SD-016	0.6	1.0	18	50	4	BFL-SD-042	4.0	4.2	16	75	6
BFL-SD-017	0.6	1.0	20	50	4	BFL-SD-044	4.0	4.2	18	75	6
BFL-SD-018	0.6	1.0	22	50	4	BFL-SD-046	4.0	4.2	20	75	6
BFL-SD-019	0.6	1.0	24	50	4	BFL-SD-048	4.0	4.2	22	75	6
BFL-SD-020	0.6	1.0	26	50	4	BFL-SD-050	4.0	4.2	24	75	6
BFL-SD-021	0.6	1.0	28	50	4	BFL-SD-052	4.0	4.2	26	75	6
BFL-SD-022	0.6	1.0	30	50	4	BFL-SD-054	4.0	4.2	28	75	6
BFL-SD-023	0.6	1.0	32	50	4	BFL-SD-056	4.0	4.2	30	75	6
BFL-SD-024	0.6	1.0	34	50	4	BFL-SD-058	4.0	4.2	32	75	6
BFL-SD-025	0.6	1.0	36	50	4	BFL-SD-060	4.0	4.2	34	75	6
BFL-SD-026	0.6	1.0	38	50	4	BFL-SD-062	4.0	4.2	36	75	6
BFL-SD-027	0.6	1.0	40	50	4	BFL-SD-064	4.0	4.2	38	75	6
BFL-SD-028	0.6	1.0	42	50	4	BFL-SD-066	4.0	4.2	40	75	6
BFL-SD-029	0.6	1.0	44	50	4	BFL-SD-068	4.0	4.2	42	75	6
BFL-SD-030	0.6	1.0	46	50	4	BFL-SD-070	4.0	4.2	44	75	6
BFL-SD-031	0.6	1.0	48	50	4	BFL-SD-072	4.0	4.2	46	75	6
BFL-SD-032	0.6	1.0	50	50	4	BFL-SD-074	4.0	4.2	48	75	6
BFL-SD-033	0.6	1.0	52	50	4	BFL-SD-076	4.0	4.2	50	75	6
BFL-SD-034	0.6	1.0	54	50	4	BFL-SD-078	4.0	4.2	52	75	6
BFL-SD-035	0.6	1.0	56	50	4	BFL-SD-080	4.0	4.2	54	75	6
BFL-SD-036	0.6	1.0	58	50	4	BFL-SD-082	4.0	4.2	56	75	6
BFL-SD-037	0.6	1.0	60	50	4	BFL-SD-084	4.0	4.2	58	75	6
BFL-SD-038	0.6	1.0	62	50	4	BFL-SD-086	4.0	4.2	60	75	6
BFL-SD-039	0.6	1.0	64	50	4	BFL-SD-088	4.0	4.2	62	75	6
BFL-SD-040	0.6	1.0	66	50	4	BFL-SD-090	4.0	4.2	64	75	6
BFL-SD-041	0.6	1.0	68	50	4	BFL-SD-092	4.0	4.2	66	75	6
BFL-SD-042	0.6	1.0	70	50	4	BFL-SD-094	4.0	4.2	68	75	6
BFL-SD-043	0.6	1.0	72	50	4	BFL-SD-096	4.0	4.2	70	75	6
BFL-SD-044	0.6	1.0	74	50	4	BFL-SD-098	4.0	4.2	72	75	6
BFL-SD-045	0.6	1.0	76	50	4	BFL-SD-100	4.0	4.2	74	75	6
BFL-SD-046	0.6	1.0	78	50	4	BFL-SD-102	4.0	4.2	76	75	6
BFL-SD-047	0.6	1.0	80	50	4	BFL-SD-104	4.0	4.2	78	75	6
BFL-SD-048	0.6	1.0	82	50	4	BFL-SD-106	4.0	4.2	80	75	6
BFL-SD-049	0.6	1.0	84	50	4	BFL-SD-108	4.0	4.2	82	75	6
BFL-SD-050	0.6	1.0	86	50	4	BFL-SD-110	4.0	4.2	84	75	6
BFL-SD-051	0.6	1.0	88	50	4	BFL-SD-112	4.0	4.2	86	75	6
BFL-SD-052	0.6	1.0	90	50	4	BFL-SD-114	4.0	4.2	88	75	6
BFL-SD-053	0.6	1.0	92	50	4	BFL-SD-116	4.0	4.2	90	75	6
BFL-SD-054	0.6	1.0	94	50	4	BFL-SD-118	4.0	4.2	92	75	6
BFL-SD-055	0.6	1.0	96	50	4	BFL-SD-120	4.0	4.2	94	75	6
BFL-SD-056	0.6	1.0	98	50	4	BFL-SD-122	4.0	4.2	96	75	6
BFL-SD-057	0.6	1.0	100	50	4	BFL-SD-124	4.0	4.2	98	75	6
BFL-SD-058	0.6	1.0	102	50	4	BFL-SD-126	4.0	4.2	100	75	6
BFL-SD-059	0.6	1.0	104	50	4	BFL-SD-128	4.0	4.2	102	75	6
BFL-SD-060	0.6	1.0	106	50	4	BFL-SD-130	4.0	4.2	104	75	6
BFL-SD-061	0.6	1.0	108	50	4	BFL-SD-132	4.0	4.2	106	75	6
BFL-SD-062	0.6	1.0	110	50	4	BFL-SD-134	4.0	4.2	108	75	6
BFL-SD-063	0.6	1.0	112	50	4	BFL-SD-136	4.0	4.2	110	75	6
BFL-SD-064	0.6	1.0	114	50	4	BFL-SD-138	4.0	4.2	112	75	6
BFL-SD-065	0.6	1.0	116	50	4	BFL-SD-140	4.0	4.2	114	75	6
BFL-SD-066	0.6	1.0	118	50	4	BFL-SD-142	4.0	4.2	116	75	6
BFL-SD-067	0.6	1.0	120	50	4	BFL-SD-144	4.0	4.2	118	75	6
BFL-SD-068	0.6	1.0	122	50	4	BFL-SD-146	4.0	4.2	120	75	6
BFL-SD-069	0.6	1.0	124	50	4	BFL-SD-148	4.0	4.2	122	75	6
BFL-SD-070	0.6	1.0	126	50	4	BFL-SD-150	4.0	4.2	124	75	6
BFL-SD-071	0.6	1.0	128	50	4	BFL-SD-152	4.0	4.2	126	75	6
BFL-SD-072	0.6	1.0	130	50	4	BFL-SD-154	4.0	4.2	128	75	6
BFL-SD-073	0.6	1.0	132	50	4	BFL-SD-156	4.0	4.2	130	75	6
BFL-SD-074	0.6	1.0	134	50	4	BFL-SD-158	4.0	4.2	132	75	6
BFL-SD-075	0.6	1.0	136	50	4	BFL-SD-160	4.0	4.2	134	75	6
BFL-SD-076	0.6	1.0	138	50	4	BFL-SD-162	4.0	4.2	136	75	6
BFL-SD-077	0.6	1.0	140	50	4	BFL-SD-164	4.0	4.2	138	75	6
BFL-SD-078	0.6	1.0	142	50	4	BFL-SD-166	4.0	4.2	140	75	6
BFL-SD-079	0.6	1.0	144	50	4	BFL-SD-168	4.0	4.2	142	75	6
BFL-SD-080	0.6	1.0	146	50	4	BFL-SD-170	4.0	4.2	144	75	6
BFL-SD-081	0.6	1.0	148	50	4	BFL-SD-172	4.0	4.2	146	75	6
BFL-SD-082	0.6	1.0	150	50	4	BFL-SD-174	4.0	4.2	148	75	6
BFL-SD-083	0.6	1.0	152	50	4	BFL-SD-176	4.0	4.2	150	75	6
BFL-SD-084	0.6	1.0	154	50	4	BFL-SD-178	4.0	4.2	152	75	6
BFL-SD-085	0.6	1.0	156	50	4	BFL-SD-180	4.0	4.2	154	75	6
BFL-SD-086	0.6	1.0	158	50	4	BFL-SD-182	4.0	4.2	156	75	6
BFL-SD-087	0.6	1.0	160	50	4	BFL-SD-184	4.0	4.2	158	75	6
BFL-SD-088	0.6	1.0	162	50	4	BFL-SD-186	4.0	4.2	160	75	6
BFL-SD-089	0.6	1.0	164	50	4	BFL-SD-188	4.0	4.2	162	75	6
BFL-SD-090	0.6	1.0	166	50	4	BFL-SD-190	4.0	4.2	164	75	6
BFL-SD-091	0.6	1.0	168	50	4	BFL-SD-192	4.0	4.2	166	75	6
BFL-SD-092	0.6	1.0	170	50	4	BFL-SD-194	4.0	4.2	168	75	6
BFL-SD-093	0.6	1.0	172	50	4	BFL-SD-196	4.0	4.2	170	75	6
BFL-SD-094	0.6	1.0	174	50	4	BFL-SD-198	4.0	4.2	172	75	6
BFL-SD-095	0.6	1.0	176	50	4	BFL-SD-200	4.0	4.2	174	75	6
BFL-SD-096	0.6	1.0	178	50	4	BFL-SD-202	4.0	4.2	176	75	6
BFL-SD-097	0.6	1.0	180	50	4	BFL-SD-204	4.0	4.2	178	75	6
BFL-SD-098	0.6	1.0	182	50	4	BFL-SD-206	4.0	4.2	180	75	6
BFL-SD-099	0.6	1.0	184	50	4	BFL-SD-208	4.0	4.2	182	75	6
BFL-SD-100	0.6	1.0	186	50	4	BFL-SD-210	4.0	4.2	184	75	6
BFL-SD-101	0.6	1.0	188	50	4	BFL-SD-212	4.0	4.2	186	75	6
BFL-SD-102	0.6	1.0	190	50	4	BFL-SD-214	4.0	4.2	188	75	6
BFL-SD-103	0.6	1.0	192								

极细微粒碳化钨
Micro Grain Carbide

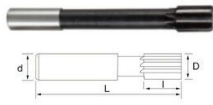

焊接铰刀
Welding Reamer



● 适合加工：铸钢、铁、铝合金、合金钢。
● 主要特性：深孔、大径的孔加工。
● Suitable for Cast Iron, Steel, Aluminum alloy and Alloy steel processing. Mainly for the processing of deep and large hole.

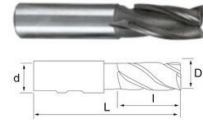

焊接铣刀
Welding cutter



● 适合加工：铸钢、铁、铝合金、合金钢。
● 主要特性：大型模具、成型孔的加工。
● Suitable for Cast Iron, Steel, Aluminum alloy and Alloy steel processing. Mainly for the processing of large die mold and shaped hole.

齿数(Z) Number of teeth	刃径(D) Outside Diameter	柄径(d) Shank Diameter	刃长(l) Flute Length	全长(L) Overall Length
4	10	10	133	87
4	12	12	151	105
4	14	14	160	110
4	15	16	162	112
4	16	16	170	120
6	17	18	175	125
6	18	18	182	130
6	20	20	195	137

产品编号 Item Code	柄径(d) Shank Diameter	齿数(Z)	尺寸(Size)		
			D	L	l
HLXM 16	16	3	16	96	32
HLXM 18	16	3	18	105	38
HLXM 20	20	3	20	105	38
HLXM 22	20	3	22	105	38
HLXM 25	25	4	25	123	45
HLXM 28	25	4	28	123	45
HLXM 30	25	4	30	131	53
HLXM 32	32	4	32	135	53
HLXM 36	32	4	36	161	53
HLXM 40	40	4	40	161	53
HLXM 45	40	4	45	161	53
HLXM 50	50	6	50	192	53
HLXM 56	50	6	56	192	63
HLXM 63	63	6	63	202	63

刀柄系列 Handle series



极细微粒碳化钨
Micro Grain Carbide

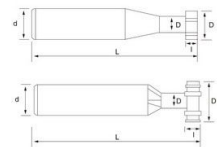

T型刀
T-slot milling cutter



● 适合加工：铸钢、铸铁、铜、铝合金、模具钢。
● 主要特性：T型槽、工件的内部沟槽。
● Suitable for Cast Iron, Stainless Steel, Copper, Aluminum alloy and Mold steel processing. Mainly for the processing of T-slot and inner slot of the workpieces.

产品编号 Model	T型槽 基本尺寸 T slot basic size	柄径 Shank Diameter	齿数之 Number of Teeth	尺寸 (Size)			
				D	L	l	d
HZTXY 12	12	12	4	21	74	9	10
HZTXY 14	14	16	6	25	82	11	12
HZTXY 18	18	16	6	32	90	14	15
HZTXY 22	22	25	6	40	108	18	19
HZTXY 28	28	32	6	50	124	22	25
HZTXY 36	36	32	8	60	139	28	30

产品编号 Model	T型槽 基本尺寸 T slot basic size	莫氏锥柄 Morse	齿数之 Number of Teeth	尺寸 (Size)			
				D	L	l	d
HZTXY 12	12	MW 2	4	21	100	9	10
HZTXY 14	14	MW 2	6	25	105	11	12
HZTXY 18	18	MW 2	6	32	110	14	15
HZTXY 22	22	MW 3	6	40	140	18	19
HZTXY 28	28	MW 4	6	50	175	22	25
HZTXY 36	36	MW 4	8	60	190	28	30
HZTXY 42	42	MW 5	8	72	230	35	36
HZTXY 48	48	MW 5	8	85	240	40	42
HZTXY 54	54	MW 5	8	95	150	44	44

PCD系列 PCD series



非标系列 Non-standard series

